

Crank shaft chuck with retractable jaws

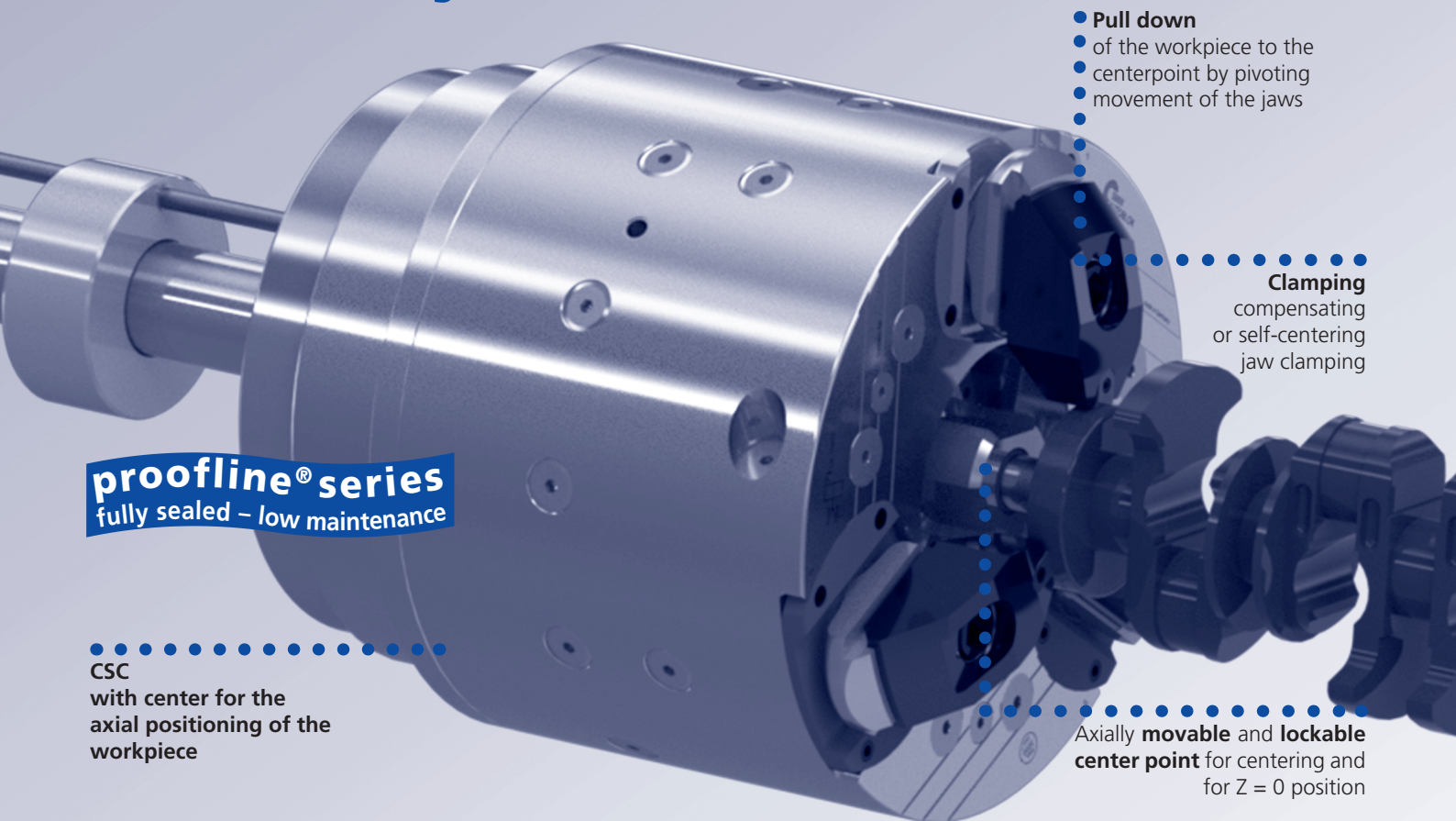

1

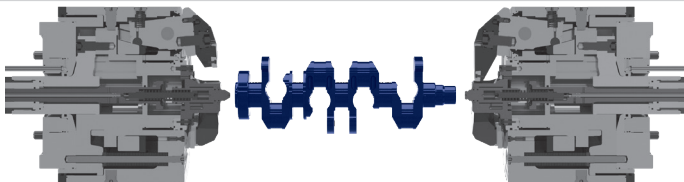

Step 1, loading of the workpiece:

- The centers are retracted
- The jaws are retracted and open

2

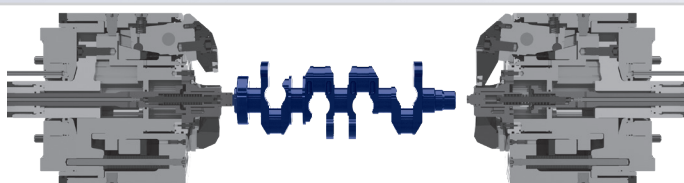

Step 2, create the Z = 0 position:

- The left center point moves forward to its end stop to create the Z = 0 position and is locked
- The jaws are retracted and open

3

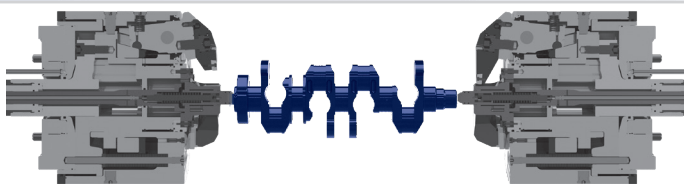

Step 3, centering the workpiece:

- the right center moves forward to center the workpiece between the 2 centers and is locked

4

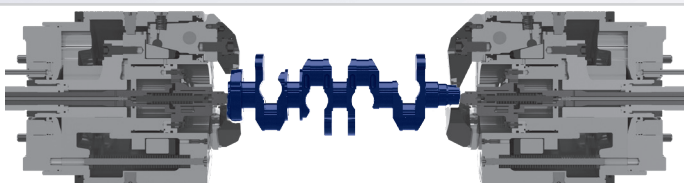

Step 4, clamping the workpiece:

- The jaws move forward and clamp the work piece with a pull down effect
- The jaw carrier is locked

Clamping glossary

Pull down: The jaws of the CSC crankshaft chuck clamp inwards by means of a pivoting movement. This generates a **pull-down movement in the Z axis - in the direction of the centering point**. This pull-down movement **prevents the crankshaft from being pushed off the center point** and keeps the crankshaft exactly stable in the center axis. This guarantees **high concentricity accuracies**.

Sealing: The CSC crankshaft chuck is completely sealed and **protected against dirt and coolant**. This prevents inaccuracies, malfunctions and increased wear and makes the system **extremely reliable**.

Low Maintenance: The CSC crankshaft chuck is equipped with **permanent oil bath lubrication**. This allows **continuous operation of the machine** without regular interruptions for maintenance, which guarantees to **increase machine availability**.

Clamping: The centering point and the jaw carrier of the CSC crankshaft chuck are **hydraulically clamped in the clamping position**. This **increases the rigidity** of the clamping system and **reduces vibrations**. This is reflected in **improved workpiece quality** and **reduced tool wear**.

Balancing chambers: The CSC crankshaft chuck has radial **balancing chambers** on the outer diameter. By removing inserted balance weights the system can be easily **fine-balanced on the machine**.

CSC
with center with
tailstock function for
centering the workpiece

low maintenance
due oil bath lubrication

Balancing chambers
for fine balancing
on the machine

proofline® series
fully sealed – low maintenance

Axially **movable** and **lockable**
center point to center the work
piece (tailstock function)

QUICK JAW CHANGE IN LESS THAN 1 MINUTE

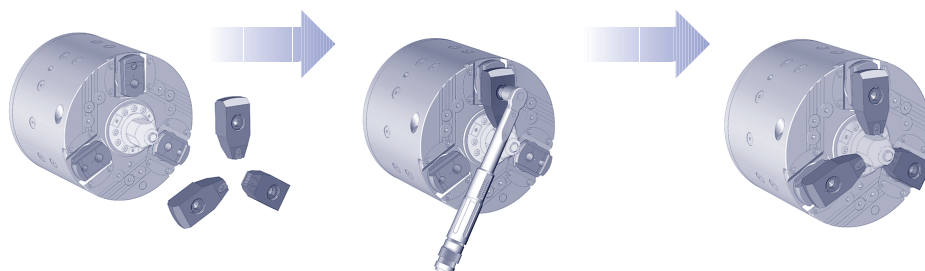

• QUICK AND SIMPLE - NO LOOSE PARTS

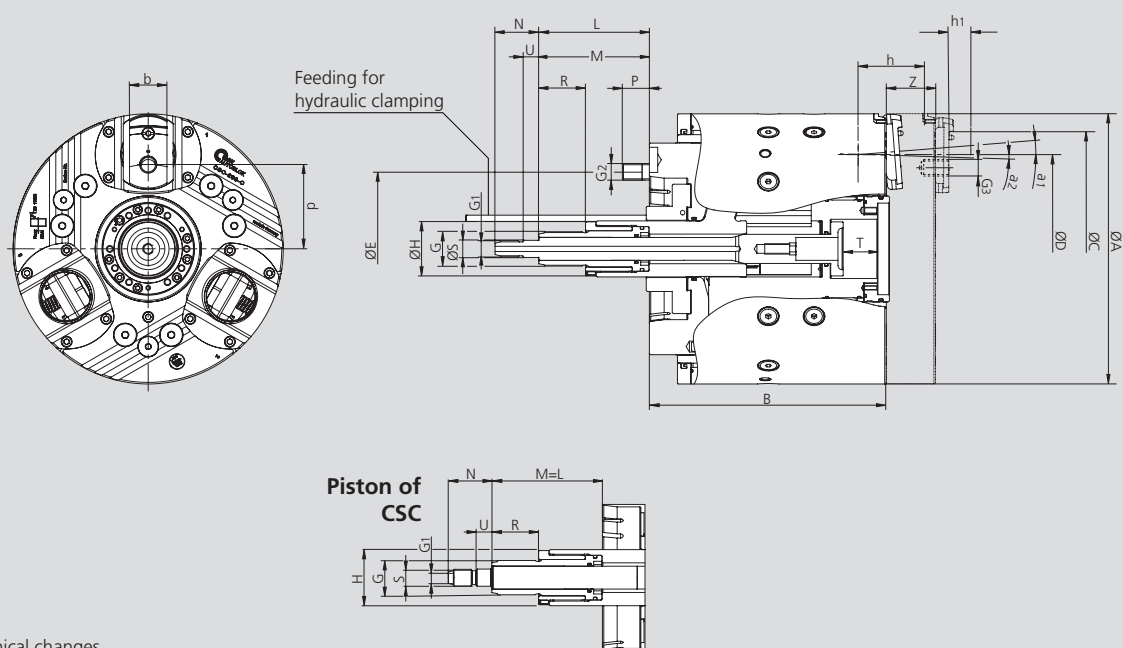

Subject to technical changes.
For more detailed information please ask our customer service.

SMW-AUTOBLOK Type		CSC-260	CSC-325
Mounting		A8	A8
Chuck outside dia.	A	260	260
Chuck height	B	228	287
In clamping position (radius)	C	R115	R115
Max. clamping dia.	D	175	175
	E	171.4	133.4
	G	M33 x 1.5	M33 x 1.5
	G1	M16	M16
	G2	M16	M16
	G3	M16 x 24	M16 x 24
	H	54	54
Push rod face driver min. / max.	L	106.3 / 66.5	123 / 83
Min. / max.	M	106.5 / 36.4	123 / 43.8
	N	42	42
	P	21	21
	R	45	45
	S ₁₆	16.5	16.5
Check dimension center insert	T	33	33
	U	15	15
Axial movement / jaw carrier	Z	53	53
Piston stroke for jaw clamping	Z1	17	17
Opening / residual stroke angle	a1/a2	4.5° / 1.3°	4.5° / 1.3°
Opening / residual stroke at distance h1	h1	4.5 / 1.3	4.5 / 1.3
Max. jaw stroke at distance h1*	mm	5.8	5.8
Max. compensating / jaw Type C	mm	± 1.0	± 1.0
	b	36	36
	d	78	78
Reference height	h	57	57
Oil volume horizontal use	l	0.50	0.50
Max. speed	r.p.m.	4000	4000
Max. draw pull	kN	55	55
Max. grip force at reference distance h*	kN	110	110
Moment of inertia	kg·m ²	0.606	0.606
Weight (without top jaws)	kg	70	70

* When exceeding distance h gripping force / speed must be reduced accordingly.



JAWS-CATALOG

Request or
download:
www.smw-autoblok.de

Supply range:

Compensating clamping (Type C) chuck with mounting bolts and mounting keys, oil

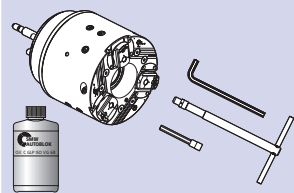

Spindle mounting \ Type C	CSC-260	CSC-325
A6	-	-
A8	162600	-
A11	-	-
A15	-	-

Actuating cylinder

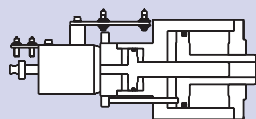

Double piston cylinder \ Type	W-215
DCN	125-30 / 87 / 40
Id. No.	046796

Centering inserts

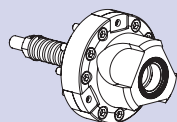

Centering insert main and subspindle (without custom center point)

CSC-260	CSC-325
209285	5315643

Oil



Oil for permanent oil bath lubrication

Oil specification	CGLP ISO VG 68
Contents	1 liter / 1.05 quart (U.S.)
Id. No.	197859